

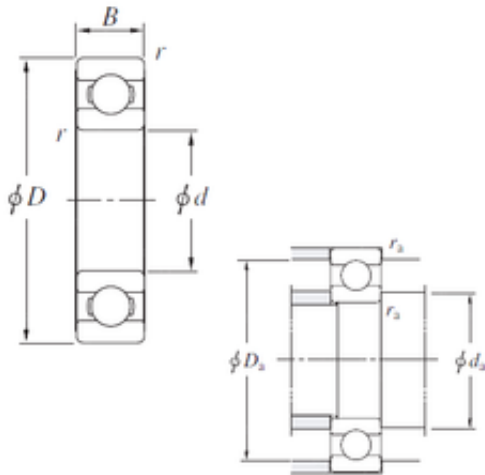

BEARING PRECISION AXLE CORP.



380 mm x 520 mm x 65 mm KOYO 6976 deep groove ball bearings

Bearing No. 6976

6976 Bearing 2D drawings and 3D CAD models

Size	380x520x65 mm
Bore Diameter	380 mm
Outer Diameter	520 mm
Width	65 mm
d	380 mm
D	520 mm
B	65 mm
C	65 mm
r min.	4 mm
da min.	396 mm
Da max.	504 mm
ra max.	3 mm
Weight	40,8 Kg
Basic dynamic load rating (C)	352 kN
Basic static load rating (C0)	552 kN
(Grease) Lubrication Speed	920 r/min
(Oil) Lubrication Speed	1100 r/min
Bearing No.	6976
r(min)	4
Cr	440
C0r	552
Cu	17.6
f0	16.4
Grease lub.	920
Oil lub.	1100



BEARING PRECISION AXLE CORP.

da(min)	396
Da(max)	504
ra(max)	3
(Refer.)Mass(kg)	40.8